

THE
PALACE

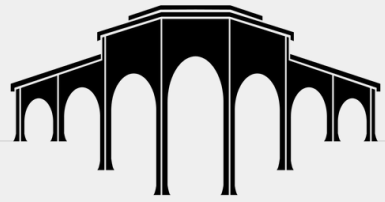

THE PALACE

PRIVATE EVENTS



02

THE PALACE MANILA SALES KIT
www.thepalacemanila.com



**BOOK YOUR EVENT AT THE
TOP NIGHTLIFE DESTINATION
IN THE COUNTRY!**

PRIVATE

EVENTS

Since it first opened its doors back in 2014, The Palace Manila has always been known as the premiere nightlife destination of the Philippines. From sustaining up to five different outlet concepts, to catering to Manila's crazy nightlife demands, to taking the party experience a notch higher by setting the standard in private events and concerts.

For private events, all outlets have fully consumable rates inclusive of venue usage, food & drinks, as well as complete equipment for guests to make use of. Choose one of four venues to celebrate life's important milestones!

04

THE PALACE MANILA SALES KIT
www.thepalacemanila.com

XYLO 1000 PAX

NIGHTCLUB • INDOOR

**1000 PAX (SEATED & STANDING))
350 PAX SEATED**



The ultimate super club of The Palace Manila group brings the Manila nightlife scene to new heights with its inspired infusion of trends and technology. Xylo boasts of a well interioered, two floor palace that can hold up to 800 people. With 5 working bars, 5 VIP sky lofts, 26 couches, cutting-edge tech and luxuriant furnishings, Xylo is the perfect venue for your big events where guests can party and have an experience of a lifetime. The ultimate super club takes you to a harmonious production of music and lights with its unique take on set design using multi-colored kinetic neon lights! Go where the future meets now: Xylo at The Palace.

05
THE PALACE MANILA SALES KIT
www.thepalacemanila.com



XYLO RATES

*For events ending past 9:00PM from Wednesday to Saturday, rates are available upon request.

*An additional fee of Php 1,000 per head will be applied for events with over 500 guests

*For bookings of 300 pax and above, whole venue rate is applied

XYLO JANUARY-OCTOBER	RATE FOR FIRST FLOOR ONLY	RATE FOR WHOLE VENUE
SUNDAY - TUESDAY	PHP 400,000	PHP 500,000
WEDNESDAY - SATURDAY *Event must end by 9PM, doors open 10PM		
XYLO NOVEMBER - DECEMBER	RATE FOR FIRST FLOOR ONLY	RATE FOR WHOLE VENUE
SUNDAY - TUESDAY	PHP 500,000	PHP 600,000
WEDNESDAY - SATURDAY *Event must end by 9PM, doors open 10PM		

INCLUSIONS

RATES ARE FULLY CONSUMABLE

- Consumable amount will be used on food and drink orders. Ratio of orders should be 50% or less for food, 50% or more for drinks

EXCLUSIVE USE OF THE VENUE

- Maximum of 6 hours; for events that fall on operational nights, event must end by 9pm

FREE USE OF THE VENUE EQUIPMENT

- Lights and sounds system, LED wall, DJ's booth, 2 wireless microphones; 20 amperes power allocation - if power requirement exceeds 20, a genset must be provided by the client

STAFFING

- Servers, bartenders, receptionists, security and utilities will be provided; quantity will depend on expected number of guests and nature of event

EXTRA CHARGES

DJ'S FEE

- Rate will depend on the choice of the DJ and number of hours

TECHNICIAN'S FEE

- Handles the venue equipment; rate will depend on the call time

ADDITIONAL HOURS

- Events exceeding 6 hours will be charged an additional consumable amount for 1 hour or fraction thereof. Exceeding hours must be agreed upon at least a week before the event.

NOTES

INGRESS TIME

- 6:00AM onwards on the date of event

*CONTRACT PRICE IS
INCLUSIVE OF 12% VAT AND
10% SERVICE CHARGE*

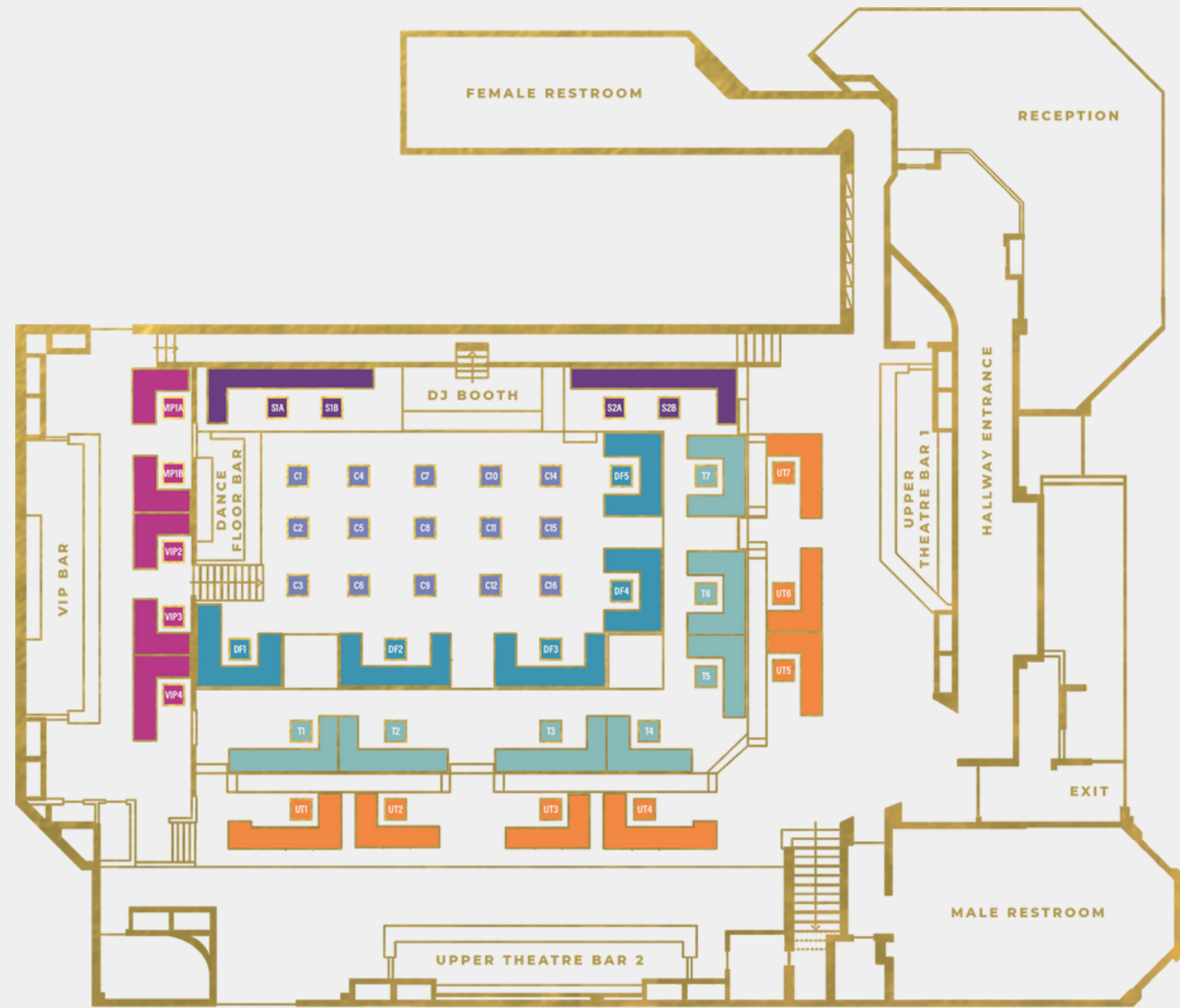

GROUND FLOOR

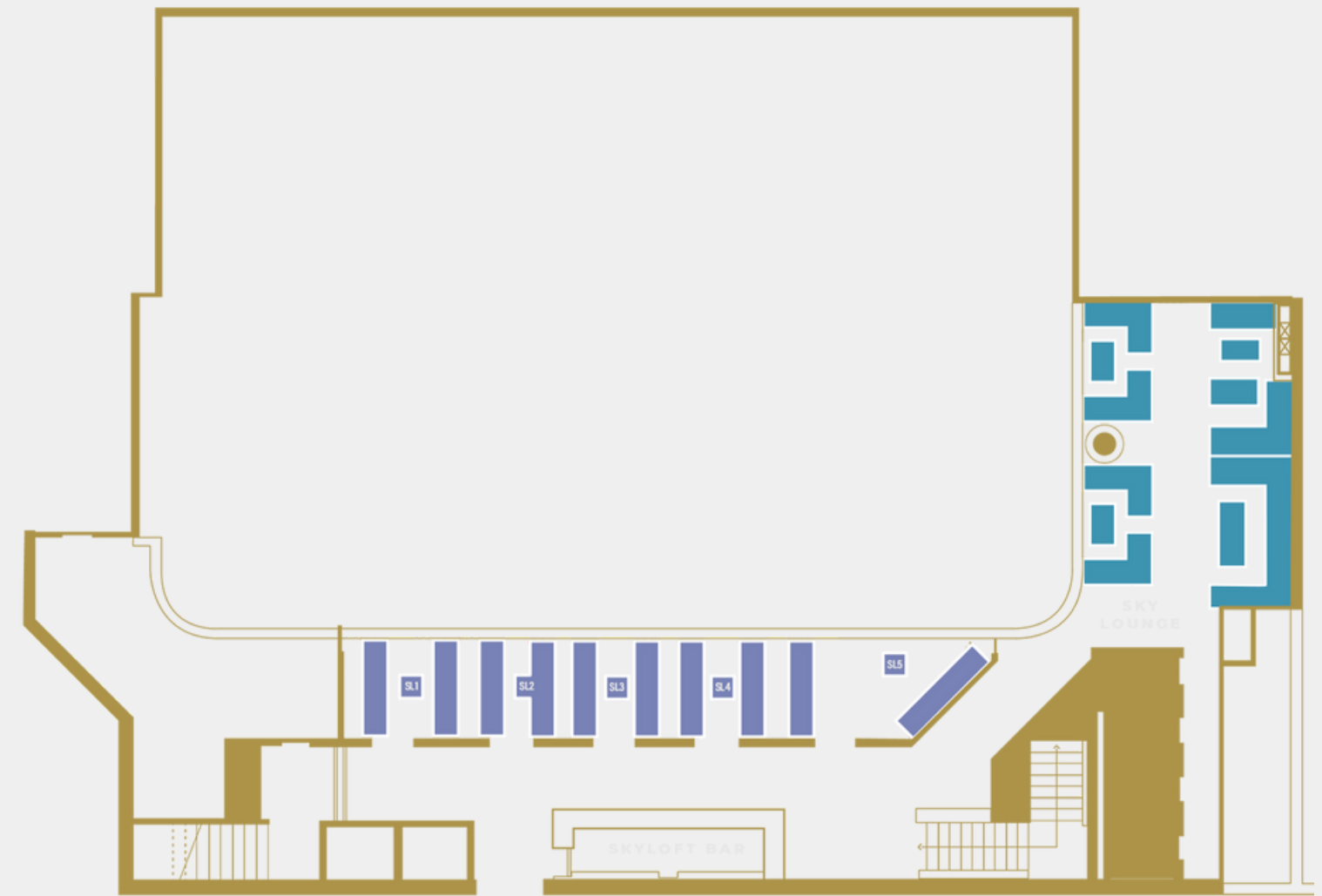

SECOND FLOOR

VENUE LAYOUT

09

THE PALACE MANILA SALES KIT
www.thepalacemanila.com

ISLAND 1000 PAX

LARGE SPACE • AL FRESCO

**1000 PAX (SEATED & STANDING))
570 PAX SEATED**

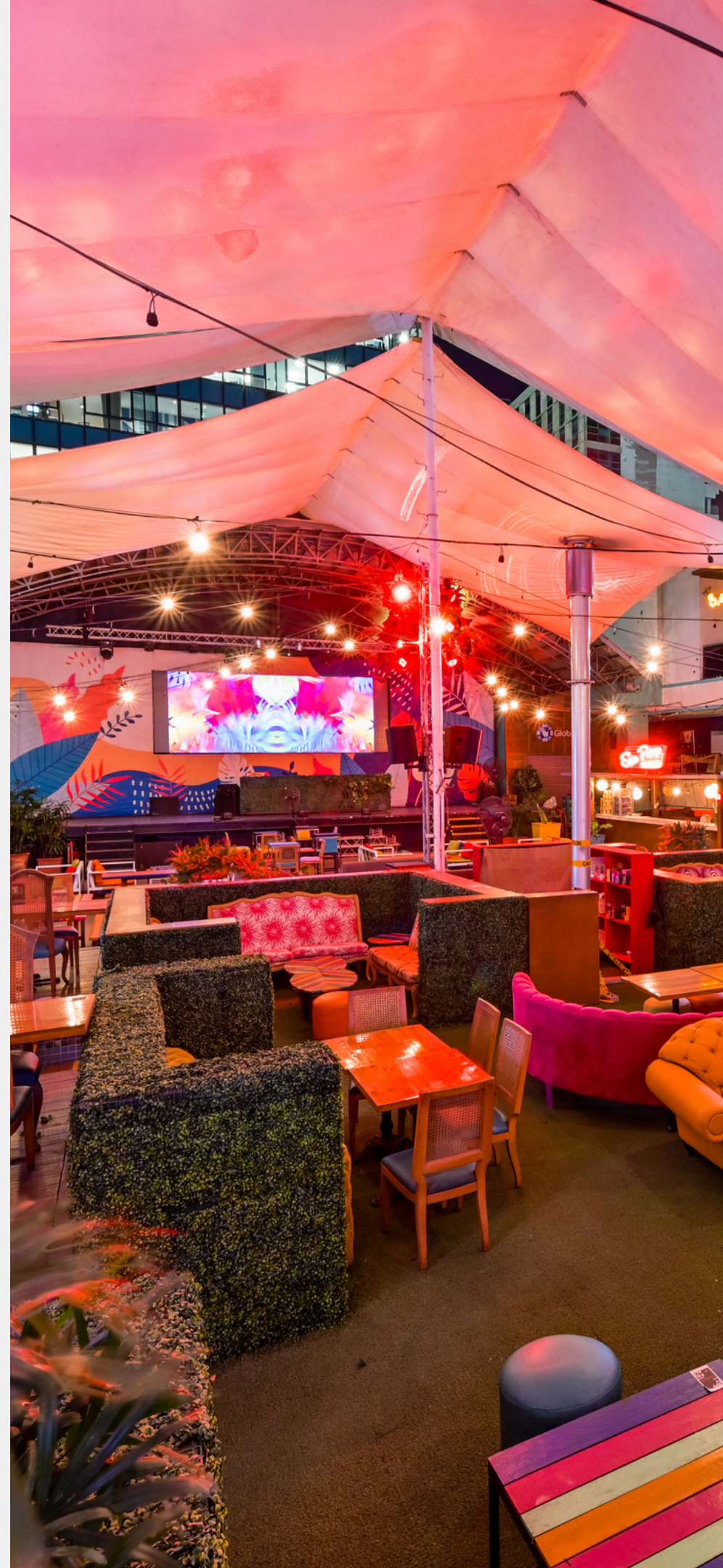

Your tropical escape right at the center of the concrete urban jungle. The Island is an al fresco dining space inspired by the beach clubs and pool clubs of Bali and Saint Tropez. A multitude of themed bars are stationed across the entire expanse such as Rum Jungle & The Hola Chica Tequila Bar. Featuring a swimming pool, a DJ's booth, and courtyard area. The venue is perfect for functions, company outings, corporate Christmas parties, conventions, trade launches, product launches and summer themed events.

10
THE PALACE MANILA SALES KIT
www.thepalacemanila.com



ISLAND RATES

ISLAND	RATE FOR HALF VENUE (January - April)	RATE FOR WHOLE VENUE (January - March)
ALL DAYS (Monday - Sunday)	PHP 150,000 Courtyard + Pool or Secret Garden + Stage	PHP 400,000

*An additional fee of Php 700 per head will be applied for events with over 500 guests (WHOLE VENUE)

*The Island will go under renovation starting April therefore only half of the venue will be available by April 1 (Courtyard + Pool) only.

INCLUSIONS

RATES ARE FULLY CONSUMABLE

- Consumable amount will be used on food and drink orders. Ratio of orders should be 50% or less for food, 50% or more for drinks

EXCLUSIVE USE OF THE VENUE

- Maximum of 6 hours.

FREE USE OF THE VENUE EQUIPMENT

- Lights and sounds system, DJ's booth, stage, 2 wireless microphones; 20 amperes power allocation - if power requirement exceeds 20, a genset must be provided by the client

STAFFING

- Servers, bartenders, receptionists, security and utilities will be provided; quantity will depend on expected number of guests and nature of event

EXTRA CHARGES

DJ'S FEE

- Rate will depend on the choice of the DJ and number of hours

TECHNICIAN'S FEE

- Handles the venue equipment; rate will depend on the call time

ADDITIONAL HOURS

- Events exceeding 6 hours will be charged an additional consumable amount for 1 hour or fraction thereof. Exceeding hours must be agreed upon at least a week before the event.

NOTES

INGRESS TIME

- 6:00AM onwards on the date of event

CONTRACT PRICE IS INCLUSIVE OF 12% VAT AND 10% SERVICE CHARGE

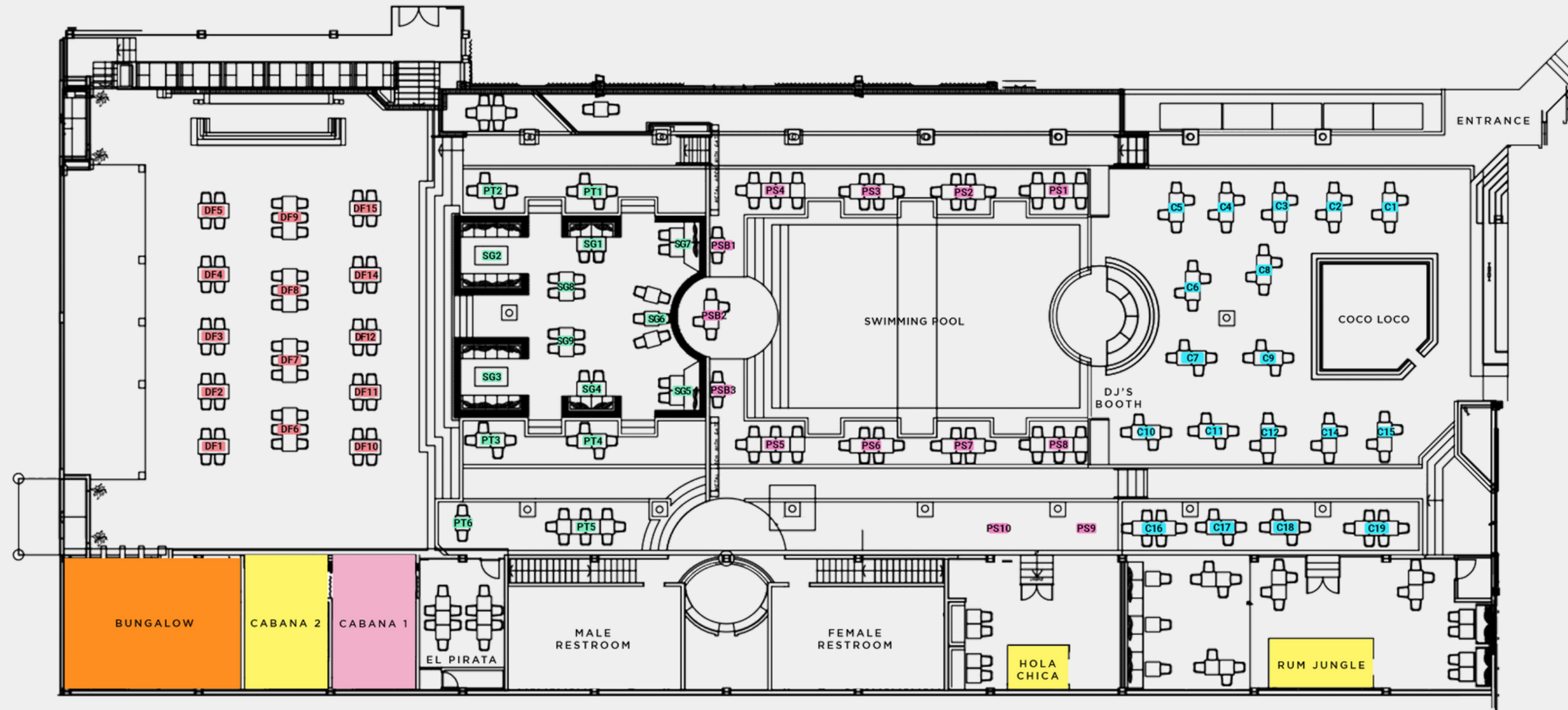

VENUE LAYOUT

14

THE PALACE MANILA SALES KIT
www.thepalacemanila.com

REVEL 350 PAX

LUXURY LOUNGE • INDOOR

350 PAX (SEATED AND STANDING)
300 PAX SEATED



Perfects the art of luxury clubbing, bringing Manila's most beautiful and accomplished people, as well as the discerning international traveller. With a maximum capacity of 350 pax, Revel is the more intimate outlet in the Palace and is perfect for functions such as media launches, dinner galas, smaller scale product launches, anniversaries and birthdays. The lounge has two floors and is equipped with three service bars, DJ's booth and serves a wide selection of signature cocktails. This lounge and luxury club is the more mature, upscale and intimate establishment, offering only 6 star VIP service and top shelf liquor. Leave the world behind and enter a place of lavish delight at Revel.

15
THE PALACE MANILA SALES KIT
www.thepalacemanila.com



REVEL RATES

REVEL JANUARY - OCTOBER	RATE FOR FIRST FLOOR ONLY	RATE FOR WHOLE VENUE
SUNDAY - TUESDAY	PHP 250,000	PHP 300,000
WEDNESDAY - SATURDAY *Event must end by 9PM; doors open 10PM		
REVEL NOVEMBER - DECEMBER	RATE FOR FIRST FLOOR ONLY	RATE FOR WHOLE VENUE
SUNDAY - TUESDAY	PHP 300,000	PHP 350,000
WEDNESDAY - SATURDAY *Event must end by 9PM; doors open 10PM		

*For events ending past 9:00PM from Wednesday to Saturday, rates are available upon request.

INCLUSIONS

RATES ARE FULLY CONSUMABLE

- Consumable amount will be used on food and drink orders. Ratio of orders should be 50% or less for food, 50% or more for drinks

EXCLUSIVE USE OF THE VENUE

- Maximum of 6 hours; for events that fall on operational nights, event must end by 9pm

FREE USE OF THE VENUE EQUIPMENT

- Lights and sounds system, DJ's booth, 2 wireless microphones; 10 amperes power allocation - if power requirement exceeds 10, a genset must be provided by the client

STAFFING

- Servers, bartenders, receptionists, security and utilities will be provided; quantity will depend on expected number of guests and nature of event

EXTRA CHARGES

DJ'S FEE

- Rate will depend on the choice of the DJ and number of hours

TECHNICIAN'S FEE

- Handles the venue equipment; rate will depend on the call time

ADDITIONAL HOURS

- Events exceeding 6 hours will be charged an additional consumable amount for 1 hour or fraction thereof. Exceeding hours must be agreed upon at least a week before the event.

NOTES

INGRESS TIME

- 6:00AM onwards on the date of event

CONTRACT PRICE IS INCLUSIVE OF 12% VAT AND 10% SERVICE CHARGE



G R O U N D F L O O R



S E C O N D F L O O R

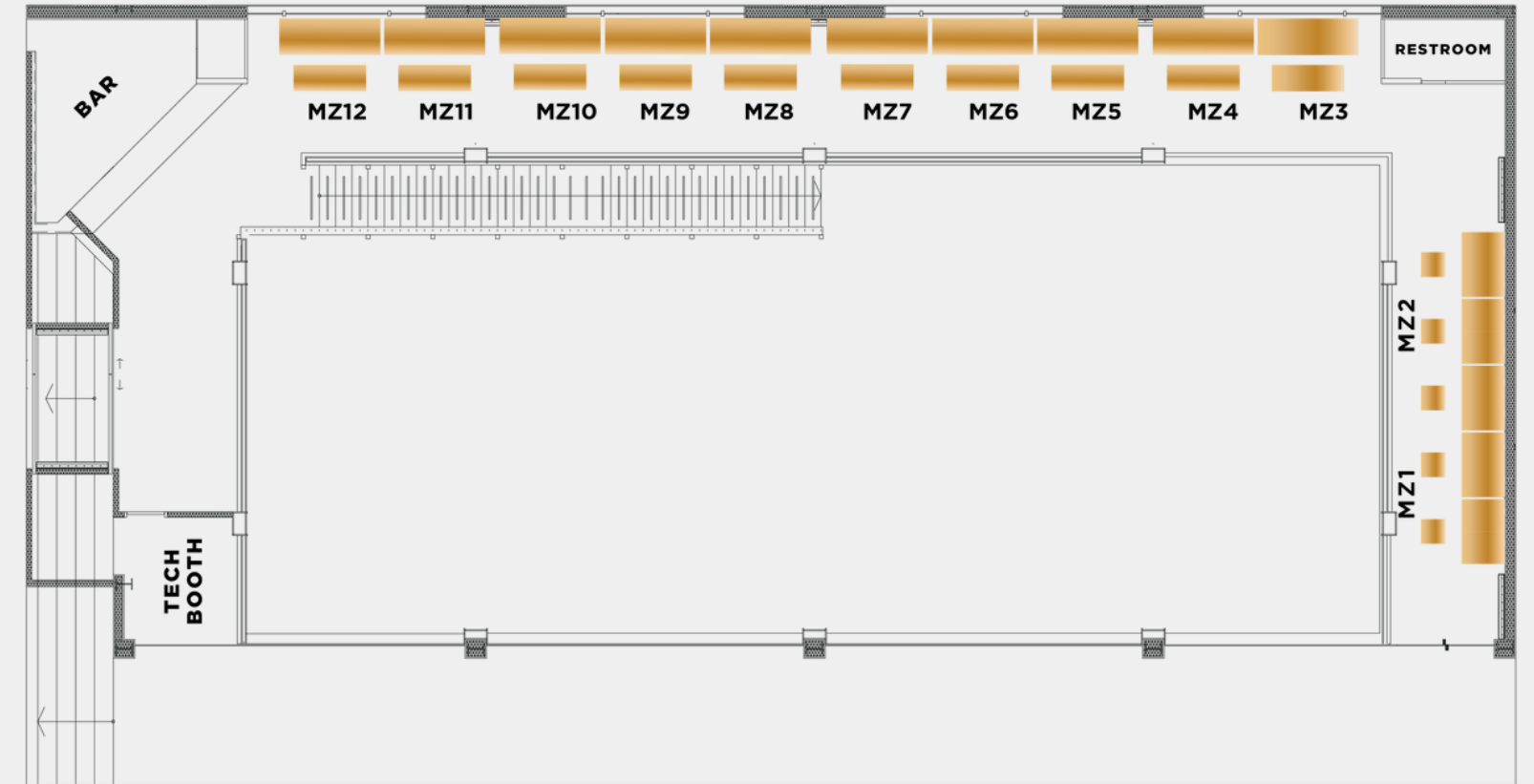
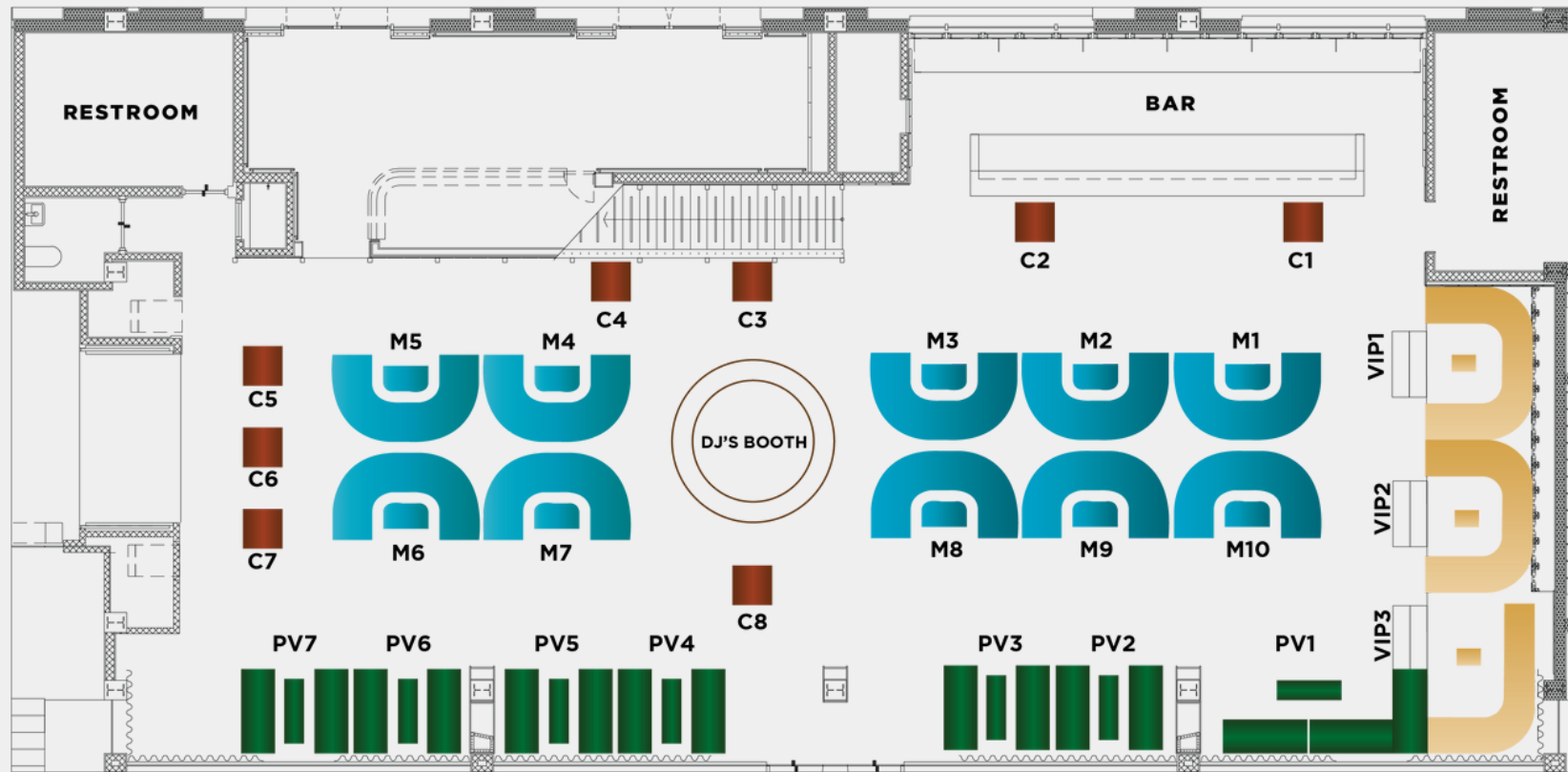

VENUE LAYOUT

19

THE PALACE MANILA SALES KIT
www.thepalacemanila.com

YES PLEASE 150 PAX

COCKTAIL BAR • INDOOR

**150 PAX (SEATED AND STANDING)
120 PAX SEATED**



The Palace's first cocktail bar concept for the ever-growing nightlife community. The venue is intricately designed to be a hip and quirky bar, complete with "clean" graffiti, neon lights and infinity mirrors. The bar's name itself harks from an 8-ball answer, which also gives major throwback feels. The venue is perfect for smaller functions with ranging guests from 40 to 120 guests such as media launches, corporate Christmas parties, product reveals and birthday parties.



YES PLEASE RATES

YES PLEASE JANUARY-OCTOBER	RATE FOR WHOLE VENUE
MONDAY - SUNDAY *Event must end by 9PM, doors open 9:30PM	PHP 80,000
YES PLEASE NOVEMBER-DECEMBER	WHOLE VENUE RATE
MONDAY - SUNDAY *Event must end by 9PM, doors open 9:30PM	PHP 95,000

*For events ending past 9:00PM from Wednesday to Saturday, rates are available upon request.

INCLUSIONS

RATES ARE FULLY CONSUMABLE

- Consumable amount will be used on food and drink orders. Ratio of orders should be 50% or less for food, 50% or more for drinks

EXCLUSIVE USE OF THE VENUE

- Maximum of 6 hours; for events that fall on operational nights, event must end by 9pm

FREE USE OF THE VENUE EQUIPMENT

- Lights and sounds system, DJ's booth, 2 wireless microphones; 10 amperes power allocation - if power requirement exceeds 10, a genset must be provided by the client

STAFFING

- Servers, bartenders, receptionists, security and utilities will be provided; quantity will depend on expected number of guests and nature of event

EXTRA CHARGES

DJ'S FEE

- Rate will depend on the choice of the DJ and number of hours

TECHNICIAN'S FEE

- Handles the venue equipment; rate will depend on the call time

ADDITIONAL HOURS

- Events exceeding 6 hours will be charged an additional consumable amount for 1 hour or fraction thereof. Exceeding hours must be agreed upon at least a week before the event.

NOTES

INGRESS TIME

- 6:00AM onwards on the date of event

CONTRACT PRICE IS INCLUSIVE OF 12% VAT AND 10% SERVICE CHARGE

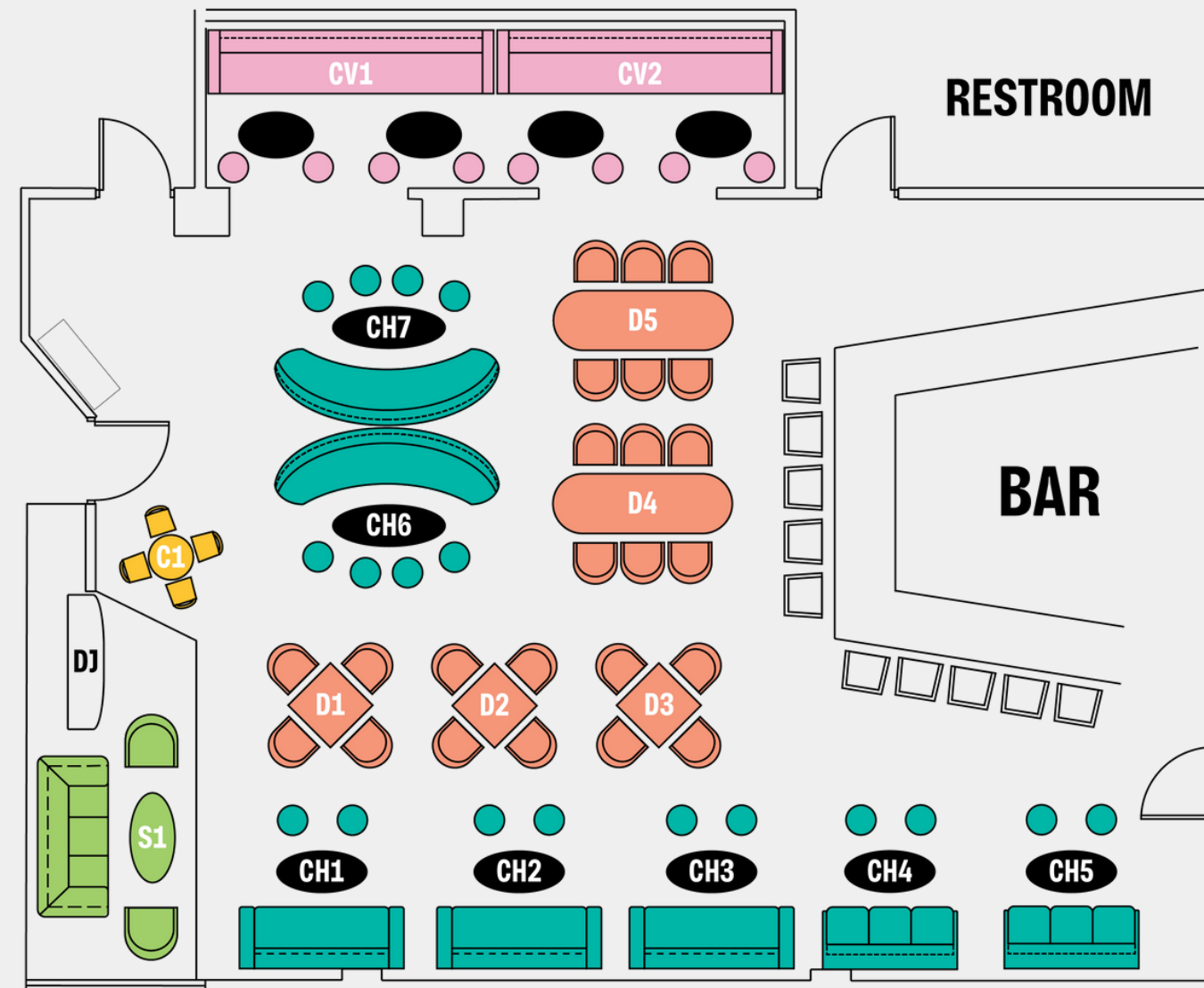

VENUE LAYOUT

24

THE PALACE MANILA SALES KIT
www.thepalacemanila.com

CLUBHOUSE 250 PAX

NIGHTCLUB • INDOOR + PATIO

**250 PAX (SEATED AND STANDING)
150 PAX SEATED**



The newest home of collective cool, a nod to the maximalist movement: your underground utopia, Clubhouse Manila.

Clubhouse is a rabbit hole of colors, accents, and concept corners! Your rabbit hole journey begins with a walkthrough on a train walkway leading to a heavily accented, super spacious seating for 250 pax and a wall takeover LED for maximum display. Miles away from the aesthetics you would expect.

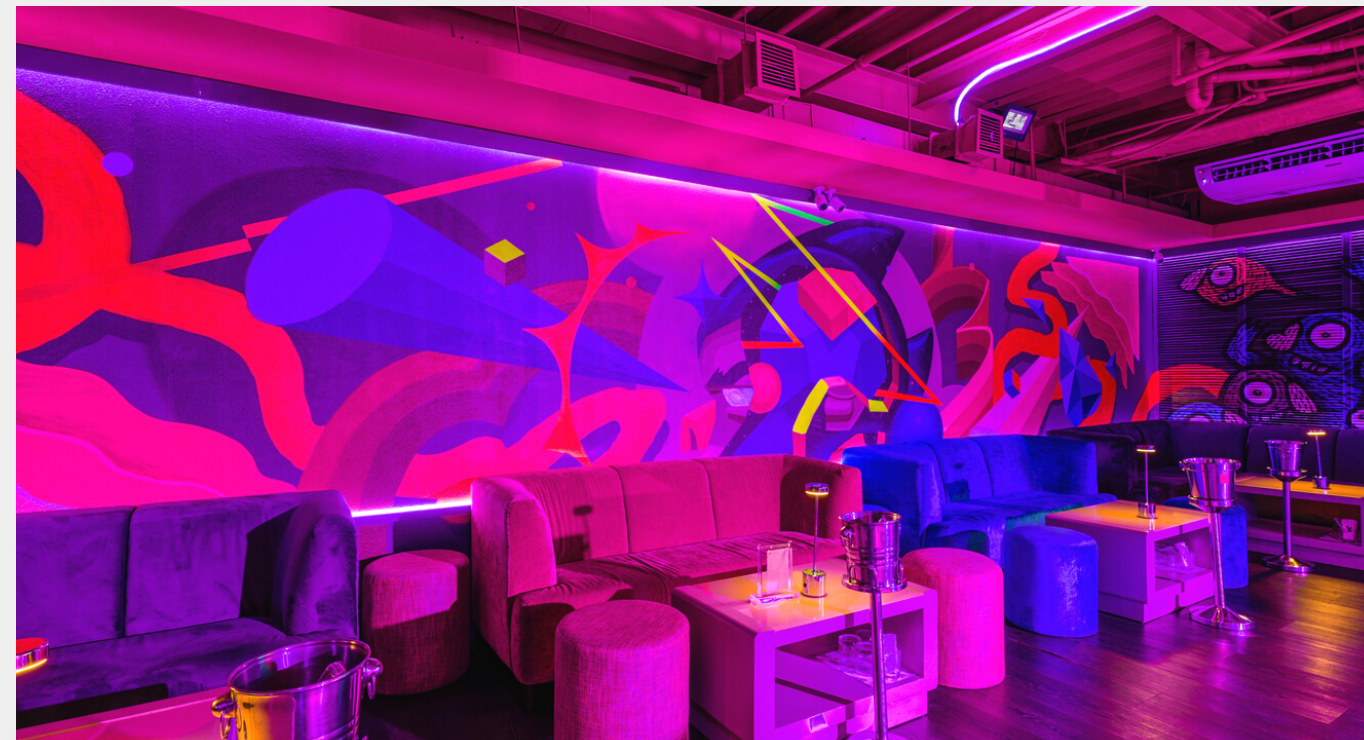
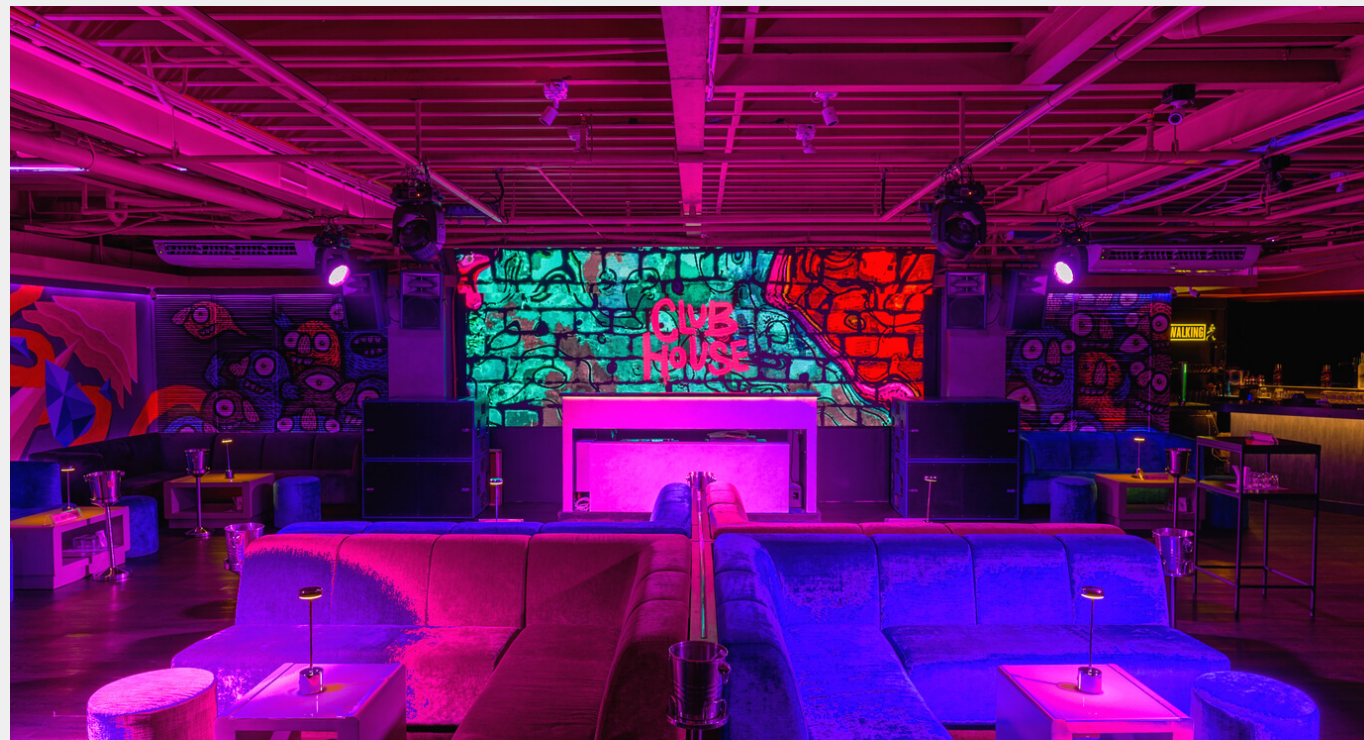

CLUBHOUSE RATES

CLUBHOUSE JANUARY TO OCTOBER	RATE FOR WHOLE VENUE
SUNDAY, MONDAY, WEDNESDAY	PHP 150,000
TUESDAY & THURSDAY *Event must end by 9PM; doors open 10PM	
FRIDAY, AND SATURDAY *Event must end by 9PM; doors open 10PM	PHP 200,000
CLUBHOUSE NOVEMBER TO DECEMBER	RATE FOR WHOLE VENUE
SUNDAY, MONDAY, WEDNESDAY	PHP 180,000
TUESDAY & THURSDAY *Event must end by 9PM; doors open 10PM	
FRIDAY, AND SATURDAY *Event must end by 9PM; doors open 10PM	PHP 250,000

*For events ending past 9:00PM from Tuesday, Thursday, Friday to Saturday, rates are available upon request.

INCLUSIONS

RATES ARE FULLY CONSUMABLE

- Consumable amount will be used on food and drink orders. Ratio of orders should be 50% or less for food, 50% or more for drinks

EXCLUSIVE USE OF THE VENUE

- Maximum of 6 hours; for events that fall on operational nights, event must end by 9pm

FREE USE OF THE VENUE EQUIPMENT

- Lights and sounds system, LED wall, DJ's booth, 2 wireless microphones; 10 amperes power allocation - if power requirement exceeds 10, a genset must be provided by the client

STAFFING

- Servers, bartenders, receptionists, security and utilities will be provided; quantity will depend on expected number of guests and nature of event

EXTRA CHARGES

DJ'S FEE

- Rate will depend on the choice of the DJ and number of hours

TECHNICIAN'S FEE

- Handles the venue equipment; rate will depend on the call time

ADDITIONAL HOURS

- Events exceeding 6 hours will be charged an additional consumable amount for 1 hour or fraction thereof. Exceeding hours must be agreed upon at least a week before the event.

NOTES

INGRESS TIME

- 6:00AM onwards on the date of event

CONTRACT PRICE IS INCLUSIVE OF 12% VAT AND 10% SERVICE CHARGE

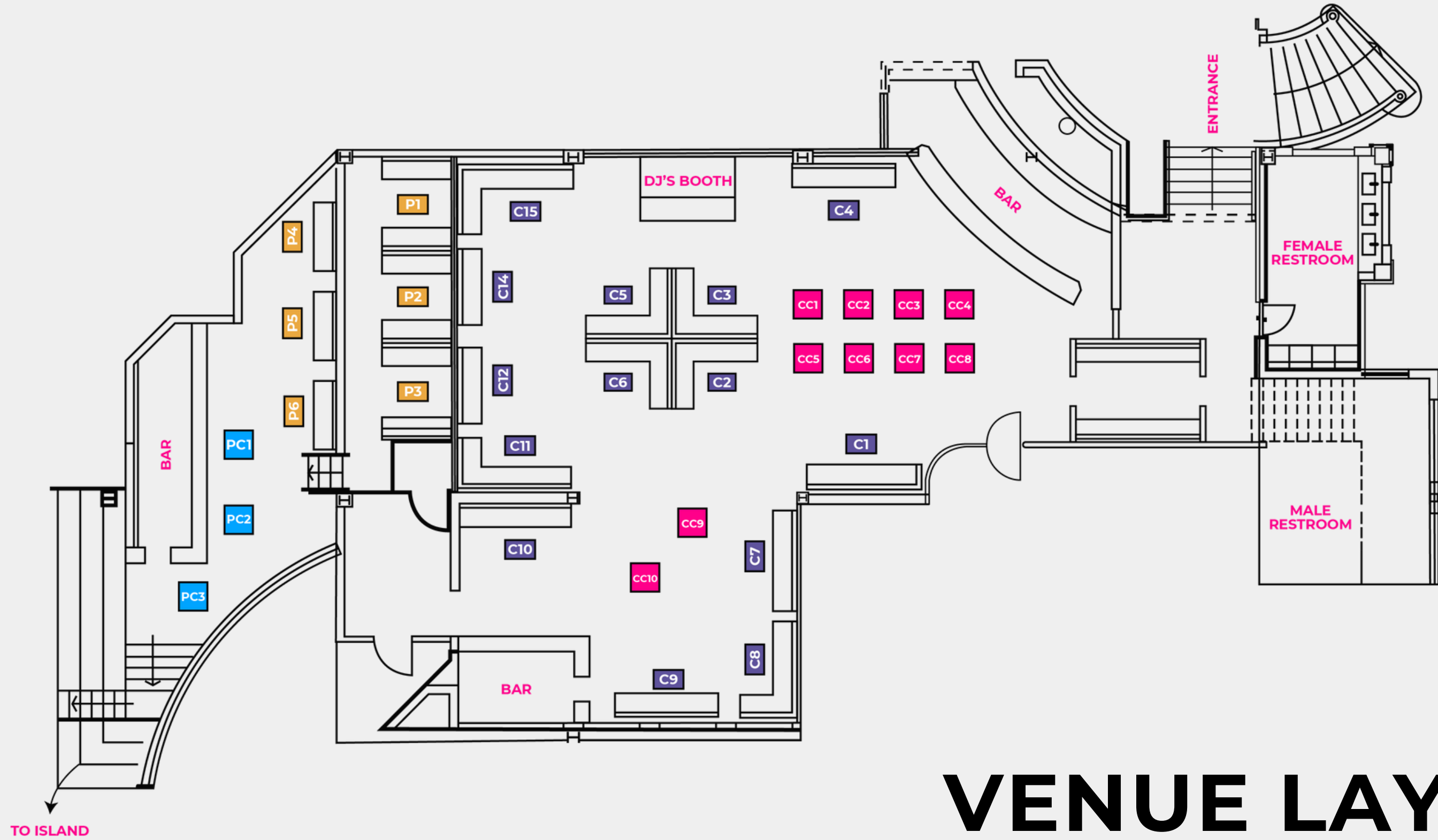

VENUE LAYOUT

BRANDS WE'VE WORKED WITH

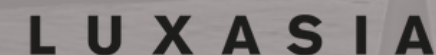

CELEBRATE YOUR PRIVATE EVENTS WITH US

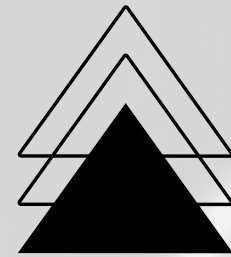

indoor &
alfresco venues

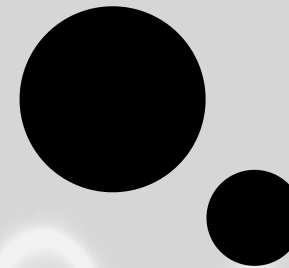

venues for
small & large
groups



fully consumable
rates for food &
drinks



complete
equipment &
facilities



staff & security
provided

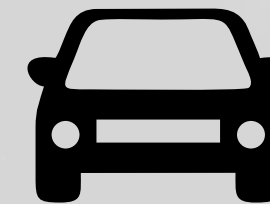

parking
available



32

THE PALACE MANILA SALES KIT
www.thepalacemanila.com

**FOR INQUIRIES, PLEASE EMAIL:
EVENTS@THEPALACEMANILA.COM**